

HOLDER MAGNETIC CAR MOUNT

MAKE YOUR LIFE SIMPLE

Specifications

Product Name	Magnetic Car Mount
Model	CTVK33
Applicable Place	Rearview Mirror
Package List	Magnetic Base x1, Rearview Mirror Clamp x1, Accessories Package x1, User Guide x1

The parameters above are derived from the laboratory of VICSEED. The actual parameters may differ from product to product or other factors. All images shown here are for reference only.

Overview

Magnetic Car Mount Parts

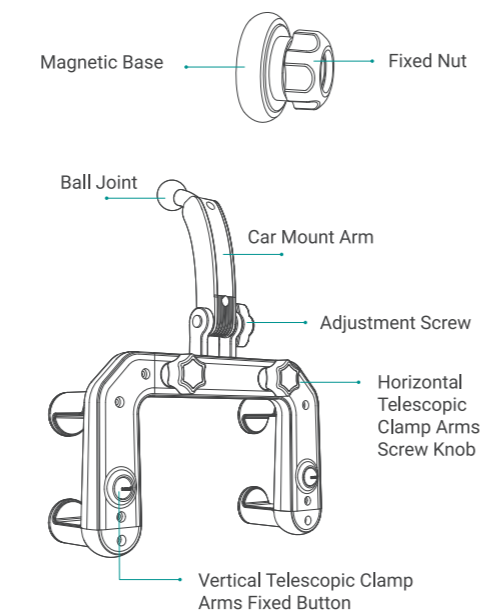

Accessories Package

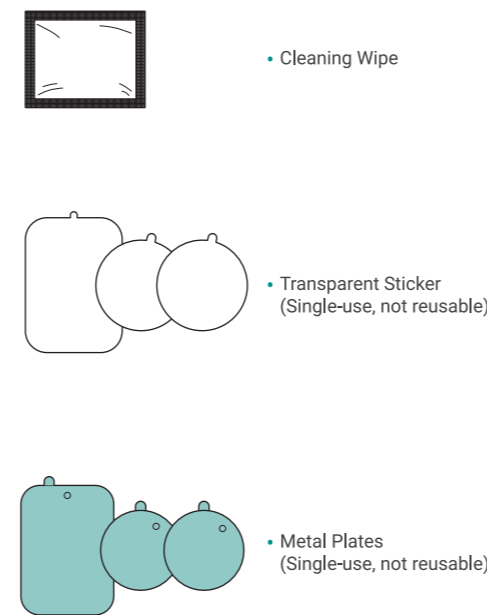

Suitability Types	Cell-phone	Thin Phone Case	Thick Phone Case	Textured Phone Case
Rectangular Transparent Sticker+Rectangular Metal Plate	✓	✓	✓	✗
Round Transparent Sticker+Thin Round Metal plate	✓	✓	✗	✗
Thick Round Metal Plate	✗	✓	✗	✓

Tips for pasting the metal plates

1. On the back of the phone: Paste a transparent sticker on it first, then attach the metal plate so it will be removed easily in the future.
2. With thin phone case: Put 1 or 2 pieces of metal plates between phone and phone case.
3. On texture phone case: Paste the thick round metal plate on the back of the phone case (No need to use transparent sticker), press and hold for 1 minute before using it.
4. Paste on flat and smooth surface only.
5. Liquid silicone cases or leather cases are not suitable.
6. For wireless charging: Do not stick the metal plate to the center on the back of the phone, as the metal will interfere with wireless charging. (It is recommended to stick the metal plate below the center of your phone case so no effect while wireless charging.)

Accessories Attaching Steps

In order to show how to attach the metal plate, we take thin round metal plate for example

1. Using a cleaning wipe to clean where the metal plate attach.

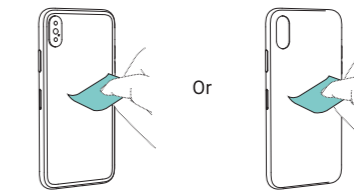

2. Tear off the protective film from the transparent sticker, then stick it to the center on the back of the phone/phone case.

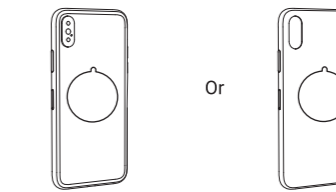

SHENZHEN HOMGMI TECHNOLOGY CO., LTD.

Add : RM1503, BLK C, Zhantao Technology BLDG, Minzhi Avenue, Minzhi ST, Longhua DIST, Shenzhen, China
Shenzhen Homgmi Technology Co., Ltd. All Rights Reserved.

Made in China

3. Tear off the protective paper and paste the metal plate onto the transparent sticker.

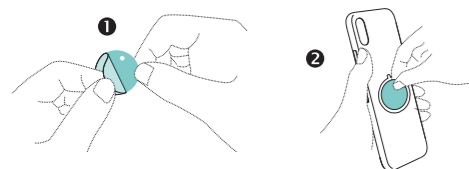

4. Press and hold them for 1 minute.

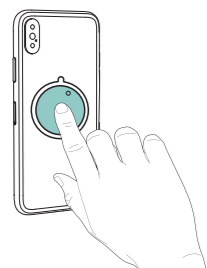

Car Mount Installation

1. Unscrew the fixed nut from the magnetic base and remove it.

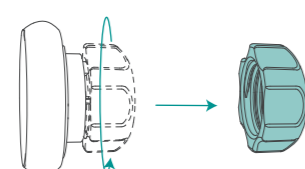

2. Loosen the adjustment screw to open the car mount arm, then tighten the adjustment screw again.

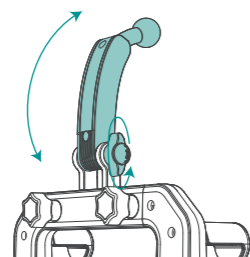

3. Put the fixed nut on the ball joint from the smaller opening side.

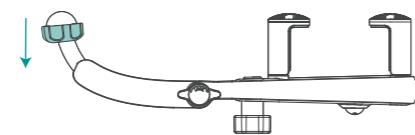

4. Push the ball joint firmly into the groove on the back of the magnetic base, then tighten the fixed nut.

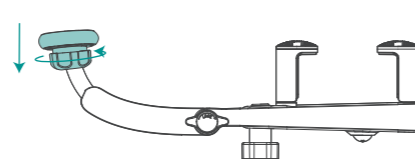

5. Pull up the four corners of the telescopic clamp arms, and pull the two corners of the upper arms outward.

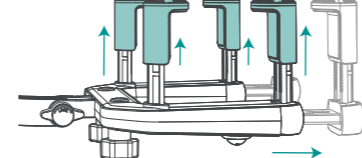

6. You can screw the horizontal telescopic clamp arms screw knob to adjust the length of the rearview mirror clamp to fit the length of your rearview mirror.

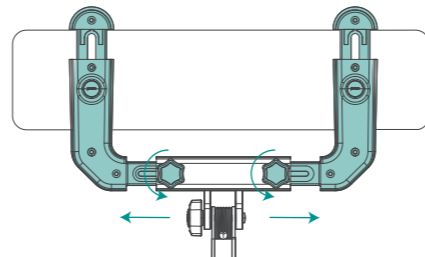

7. Install the rearview mirror car mount onto the rearview mirror, and then press the telescopic clamp arms fixed button to lock the rearview mirror.

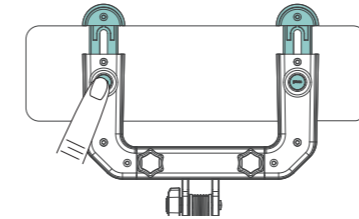

8. The rearview mirror car mount can be fixed by resetting the four corners of the telescopic clamp arms.

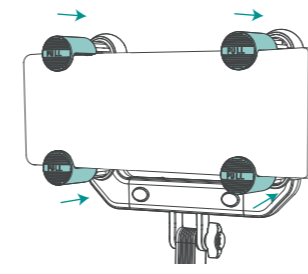

9. Loosen the adjustment screw to adjust the car mount arm to the best angle.

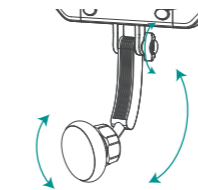

10. Put the mobile phone with the metal plates on the magnetic base, then you can use it.

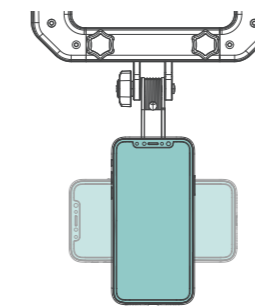

FAQs

Affect wireless charging

All metal would affect wireless charging. To avoid this occasion, do not paste the metal plate to the center of the back of the phone. If your phone case pasted with metal plate, please remove the case before charging.

Magnetic power is not strong / Phone falls

1. Magnetic suction bearing is limited. If your phone or phone case is heavy, you can attach a metal plate to the outside of the phone case and sandwich a metal plate between your phone and phone case to increase the suction.
2. Please paste the metal plate to the center of the phone to ensure that the gravity center is stable enough.

Metal plate or transparent sticker can't stick

1. If the metal plate and transparent sticker are not pasted firmly, please check whether they are installed correctly.
2. Make sure the back of your phone or phone case material is not leather, liquid silicone, or other matte surfaces. (These types of surface plate are not suitable for pasting metal plate and transparent sticker.)

Attentions

- Avoid dropping.
- Do not disassemble.
- Do not install while driving.

- Please keep this product away from any magnetic items, otherwise, demagnetization might happen.
- Please keep the accessories for replacement.
- Keep the car mount away from children.

Customer Service

- 12-month limited warranty
- Lifetime technical support
- support@vicseed.com
- www.vicseed.com

Any question, please feel free to contact us. Fix issue within 24 hours.

SCAN THE CODE TO WATCH USING VIDEO

